

COPYRIGHT © Hangzhou EZVIZ Software Co., Ltd.. ALL RIGHTS RESERVED.

Any and all information, including, among others, wordings, pictures, graphs are the properties of Hangzhou EZVIZ Software Co., Ltd. (hereinafter referred to as "EZVIZ"). This user manual (hereinafter referred to as "the Manual") cannot be reproduced, changed, translated, or distributed, partially or wholly, by any means, without the prior written permission of EZVIZ. Unless otherwise stipulated, EZVIZ does not make any warranties, guarantees or representations, express or implied, regarding to the Manual.

About this Manual

The Manual includes instructions for using and managing the product. Pictures, charts, images and all other information hereinafter are for description and explanation only. The information contained in the Manual is subject to change, without notice, due to firmware updates or other reasons. Please find the latest version in the EZVIZ™ website (<http://www.ezvizlife.com>).

Revision Record

New release – January, 2019

Trademarks Acknowledgement

EZVIZ™, ™, and other EZVIZ's trademarks and logos are the properties of EZVIZ in various jurisdictions. Other trademarks and logos mentioned below are the properties of their respective owners.

Legal Disclaimer

TO THE MAXIMUM EXTENT PERMITTED BY APPLICABLE LAW, THE PRODUCT DESCRIBED, WITH ITS HARDWARE, SOFTWARE AND FIRMWARE, IS PROVIDED "AS IS", WITH ALL FAULTS AND ERRORS, AND EZVIZ MAKES NO WARRANTIES, EXPRESS OR IMPLIED, INCLUDING WITHOUT LIMITATION, MERCHANTABILITY, SATISFACTORY QUALITY, FITNESS FOR A PARTICULAR PURPOSE, AND NON-INFRINGEMENT OF THIRD PARTY. IN NO EVENT WILL EZVIZ, ITS DIRECTORS, OFFICERS, EMPLOYEES, OR AGENTS BE LIABLE TO YOU FOR ANY SPECIAL, CONSEQUENTIAL, INCIDENTAL, OR INDIRECT DAMAGES, INCLUDING, AMONG OTHERS, DAMAGES FOR LOSS OF BUSINESS PROFITS, BUSINESS INTERRUPTION, OR LOSS OF DATA OR DOCUMENTATION, IN CONNECTION WITH THE USE OF THIS PRODUCT, EVEN IF EZVIZ HAS BEEN ADVISED OF THE POSSIBILITY OF SUCH DAMAGES.

TO THE MAXIMUM EXTENT PERMITTED BY APPLICABLE LAW, IN NO EVENT SHALL EZVIZ'S TOTAL LIABILITY FOR ALL DAMAGES EXCEED THE ORIGINAL PURCHASE PRICE OF THE PRODUCT.

EZVIZ DOES NOT UNDERTAKE ANY LIABILITY FOR PERSONAL INJURY OR PROPERTY DAMAGE AS THE RESULT OF PRODUCT INTERRUPTION OR SERVICE TERMINATION CAUSED BY: A) IMPROPER INSTALLATION OR USAGE OTHER THAN AS REQUESTED; B) THE PROTECTION OF NATIONAL OR PUBLIC INTERESTS; C) FORCE MAJEURE; D) YOURSELF OR THE THIRD PARTY, INCLUDING WITHOUT LIMITATION, USING ANY THIRD PARTY'S PRODUCTS, SOFTWARE, APPLICATIONS, AND AMONG OTHERS.

REGARDING TO THE PRODUCT WITH INTERNET ACCESS, THE USE OF PRODUCT SHALL BE WHOLLY AT YOUR OWN RISKS. EZVIZ SHALL NOT TAKE ANY RESPONSIBILITIES FOR ABNORMAL OPERATION, PRIVACY LEAKAGE OR OTHER DAMAGES RESULTING FROM CYBER ATTACK, HACKER ATTACK, VIRUS INSPECTION, OR OTHER INTERNET SECURITY RISKS; HOWEVER, EZVIZ WILL PROVIDE TIMELY TECHNICAL SUPPORT IF REQUIRED. SURVEILLANCE LAWS AND DATA PROTECTION LAWS VARY BY JURISDICTION. PLEASE CHECK ALL RELEVANT LAWS IN YOUR JURISDICTION BEFORE USING THIS PRODUCT IN ORDER TO ENSURE THAT YOUR USE CONFORMS TO THE APPLICABLE LAW. EZVIZ SHALL NOT BE LIABLE IN THE EVENT THAT THIS PRODUCT IS USED WITH ILLEGITIMATE PURPOSES.

IN THE EVENT OF ANY CONFLICTS BETWEEN THE ABOVE AND THE APPLICABLE LAW, THE LATTER PREVAILS.

Obsah balenia

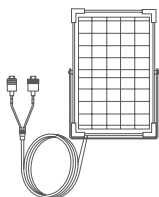

Solárny panel



Súprava skrutiek



Šablóna na vrtanie



Stručná úvodná príručka

Inštalácia

- i** **VÝSTRAHA:** Množstvo energie vytvárané týmto solárnym panelom, ktorý slúži ako alternatívne nabíjacie zariadenie, môže byť ovplyvnené skutočným okolitým prostredím, najmä intenzitou slnečného žiarenia a trvaním osvetlenia. Ak sa kamera napájaná batériou čoskoro vybije, je potrebné pamätať na to, že len samotný solárny panel nedokáže zabezpečiť, že kamera zostane v prevádzkyschopnom stave.

1 Miesto inštalácie

Solárny panel umiestnite na miesto s najdlhším slnečným svitom počas celého roka a na inštaláciu zvolte vhodnú stenu alebo rovný povrch.

2 Kroky inštalácie

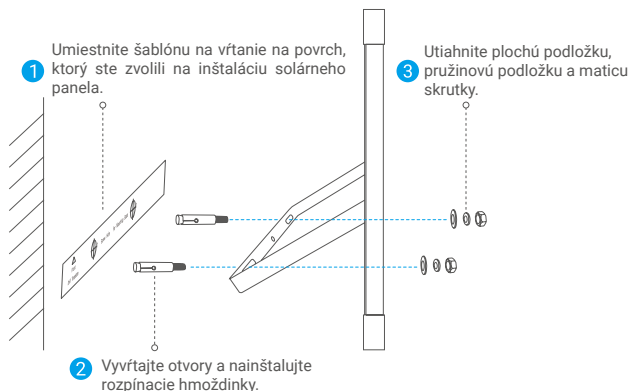

- i** Pri vrtaní otvorov pre rozpínacie hmoždinky zabezpečte, aby mal vrták priemer 10 mm až 11 mm a hĺbka otvoru bola 45 mm až 55 mm.

3 Nastavenie uhla

Uvoľnite skrutky na oboch stranách panela, nastavte uhol solárneho panela tak, aby bol vystavený priamemu slnečnému žiareniu, a potom znova utiahnite skrutky na oboch stranách.

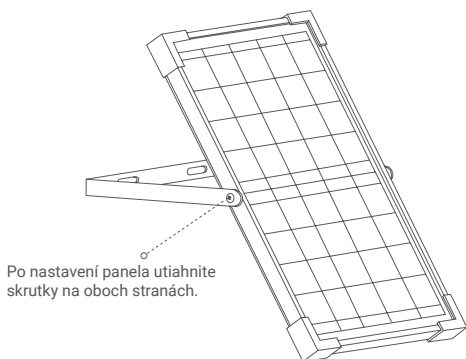

- Neumiestňujte solárny panel úplne rovnobežne s povrchom.
- Odporúčany uhol: 25° – 40°, podľa vyobrazenia nižšie.

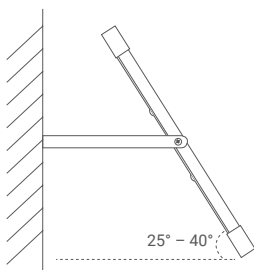

4 Pripojenie kamery

Odstráňte vodotesný koncový uzáver portu kábla podľa označenia a potom ho pripojte ku kamere napájanej batériou.

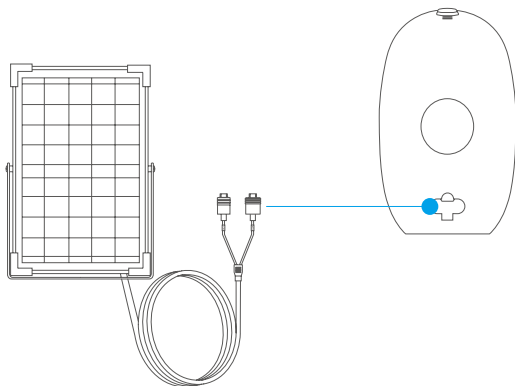

- Odstránený vodotesný koncový uzáver dobre uchovajte.
- Neodstraňujte vodotesný koncový uzáver portu kábla, ktorý sa nebude používať.
- Solárny panel nemožno prikrývať, v opačnom prípade by to malo výrazný vplyv na schopnosť fotoelektrickej konverzie solárnej energie.
 - Solárny panel pravidelne čistíte a odstraňujete prach a iné nečistoty.
- Podrobné informácie nájdete na stránke www.ezviz.eu.